

AlfaCab Series

FTTX-03

The FTTX-03 cabinet is integrated with service, power supply, monitoring, temperature control, electric counter. The compact design requires less installation costs and space. They can be installed quickly on site or top of the CCC to satisfy the demand for quick networking. The sealed design protects the FTTX-03 cabinet against dust, moisture, and rain and ensures reliable running in harsh environment. The FTTX-03 cabinet shell is the rust-protection aluminium with the coating of polyurethane powder, well protecting the cabinet against corrosion. The coating color is RAL9003, which helps effectively reduce the solar absorptivity.

Features

- ✓ Compatible for all brands 3RU Dslam/MDU/Ethernet Switches
- ✓ Water-proof and dust-proof performance, meeting requirements of the IP55(Outdoor) and IP54(Indoor) protection level
- ✓ Double wall for IP 55 and single wall for IP54
- ✓ Integrated fan cooling system
- ✓ Wall or pole or top on CCC mount options

Specifications

- ✓ Welded aluminium construction
- ✓ Durable anti graffiti powder coat finish RAL9003
- ✓ EMC and Anti-attack performance
- ✓ Special electric counter door in right side
- ✓ Compliant to RoHS
- ✓ WK2 special lock in front door

Applications

- ✓ Telecommunications Networks
- ✓ Customer Premise
- ✓ LAN / WAN Networks
- ✓ Data Communications
- ✓ Outdoor or Indoor Applications



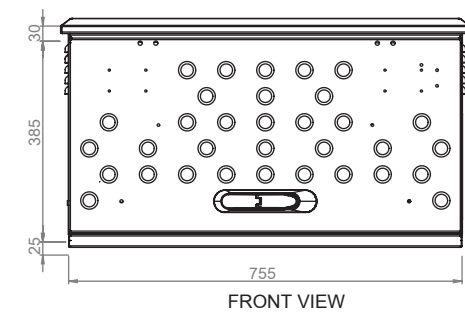

FRONT VIEW

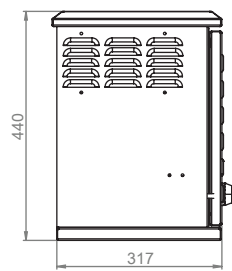

LEFT VIEW

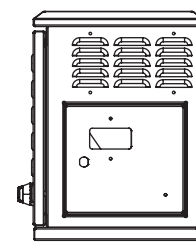

RIGHT VIEW

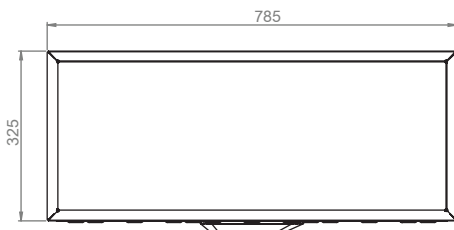

TOP VIEW

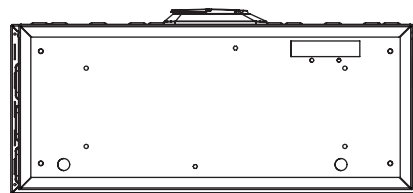

BOTTOM VIEW

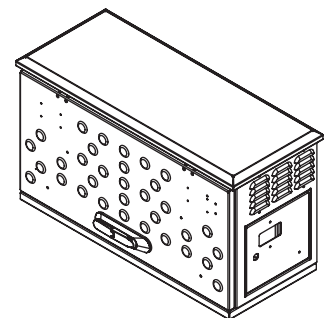

ISOMETRIC VIEW

EXPLODED VIEW

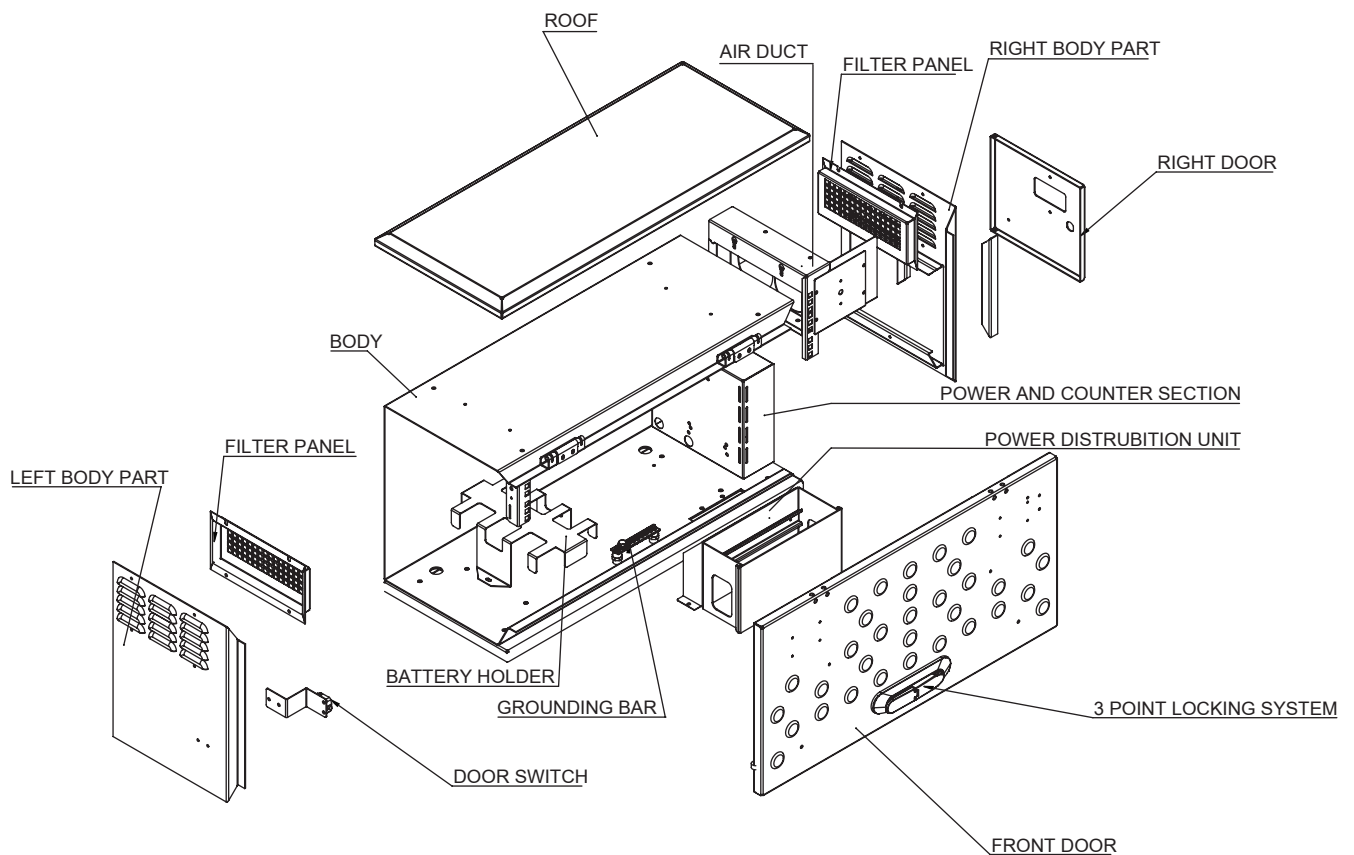

Internal Parts

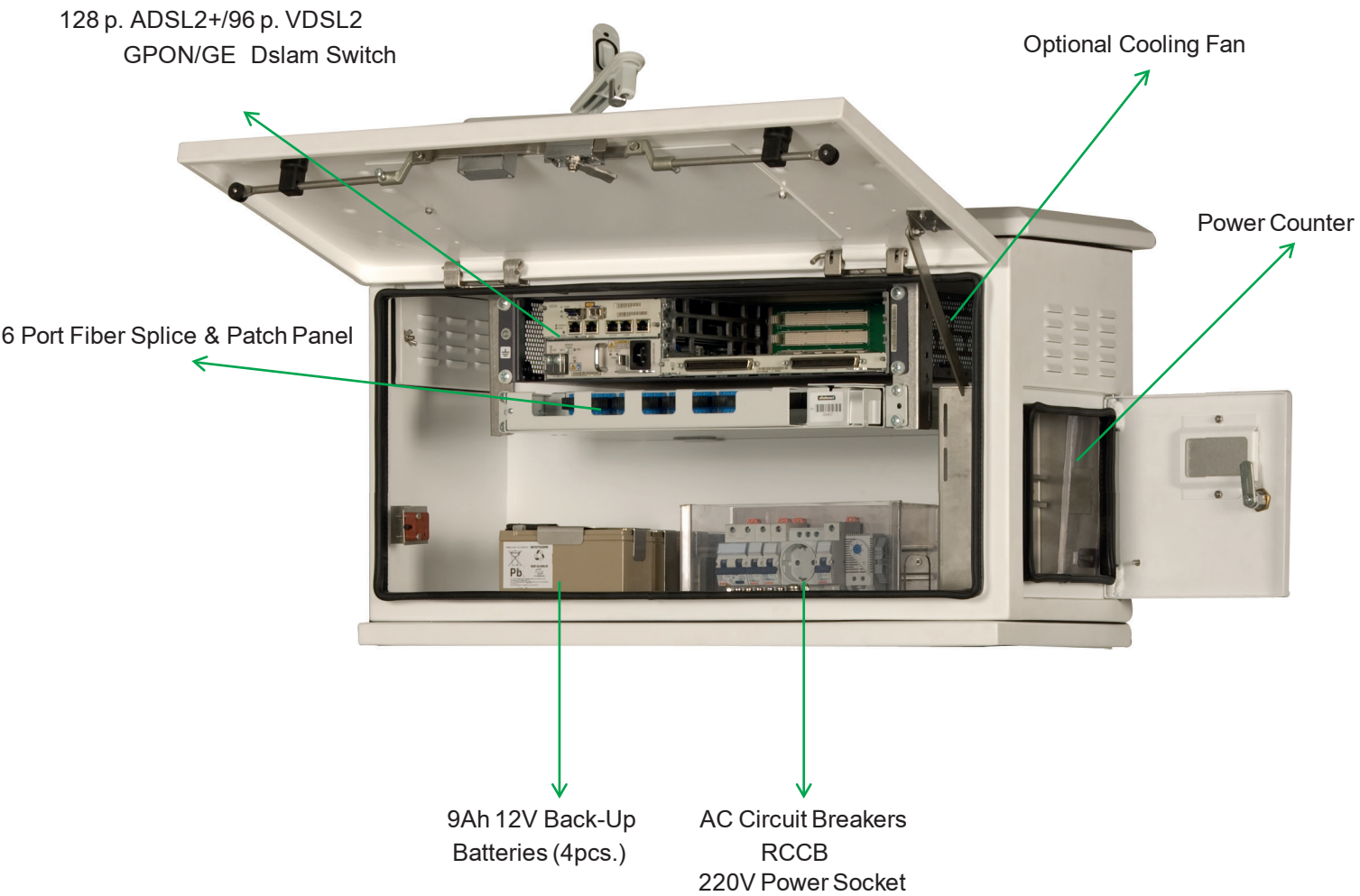

Order No*	Product Definition
ALF-CAB-FTTX-03-WT	FTTX-03 Cabinet, Colour: Ral9003 White (1 pcs. WK2 high security lock, 1 pcs. Half-cylinder lock in power meter door, 1pcs. 24 port Fiber Optic Panel, 2pcs. AC Axial Fan)