

AlfaCab Series

FTTX-01

The FTTX-01 cabinet is integrated with service, power supply, monitoring, temperature control, and cable distribution units. The compact design requires less installation costs and space. They can be installed quickly on site to satisfy the demand for quick networking. The sealed design protects the FTTX-01 cabinet against dust, moisture, and rain and ensures reliable running in harsh environment. The FTTX-01 cabinet shell is the rust-protection steel plate with the coating of polyester powder, well protecting the cabinet against corrosion. The coating color is RAL7035, which helps effectively reduce the solar absorptivity.



Features

- ✓ Compatible for all brands 1RU Dslam/MDU/Ethernet Switches
- ✓ Water-proof and dust-proof performance, meeting requirements of the IP55(Outdoor) and IP54(Indoor) protection level
- ✓ Natural air circulations with hot air outlet hood
- ✓ Wall or pole mount options

Specifications

- ✓ Welded Cold Rolled Steel Construction
- ✓ Durable textured powder coat finish RAL7035
- ✓ EMC and Anti-attack performance
- ✓ Hinged and easy openable equipment housing panel
- ✓ Compliant to RoHS

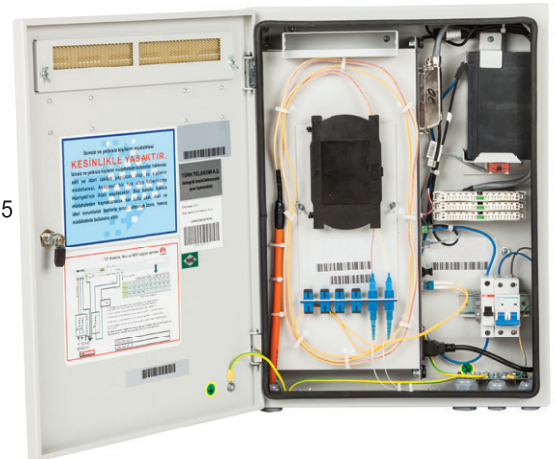

Applications

- ✓ Telecommunications Networks
- ✓ Customer Premise
- ✓ LAN / WAN Networks
- ✓ Data Communications
- ✓ Outdoor or Indoor Applications



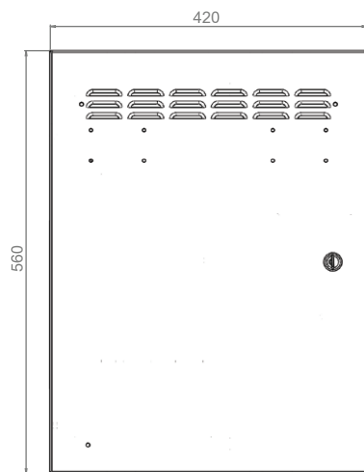

FRONT VIEW

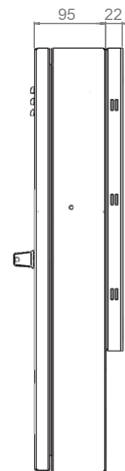

SIDE VIEW

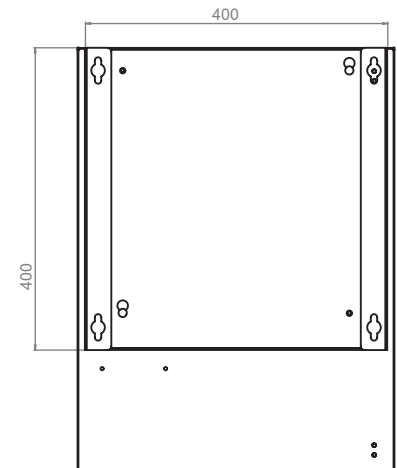

BACK VIEW

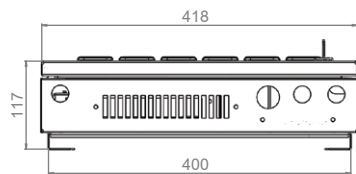

BOTTOM VIEW

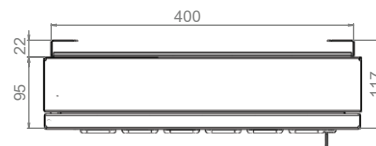

TOP VIEW

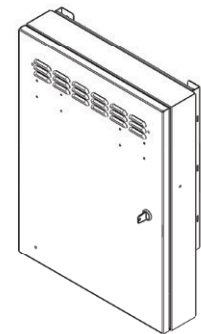

ISOMETRIC VIEW

EXPLODED VIEW

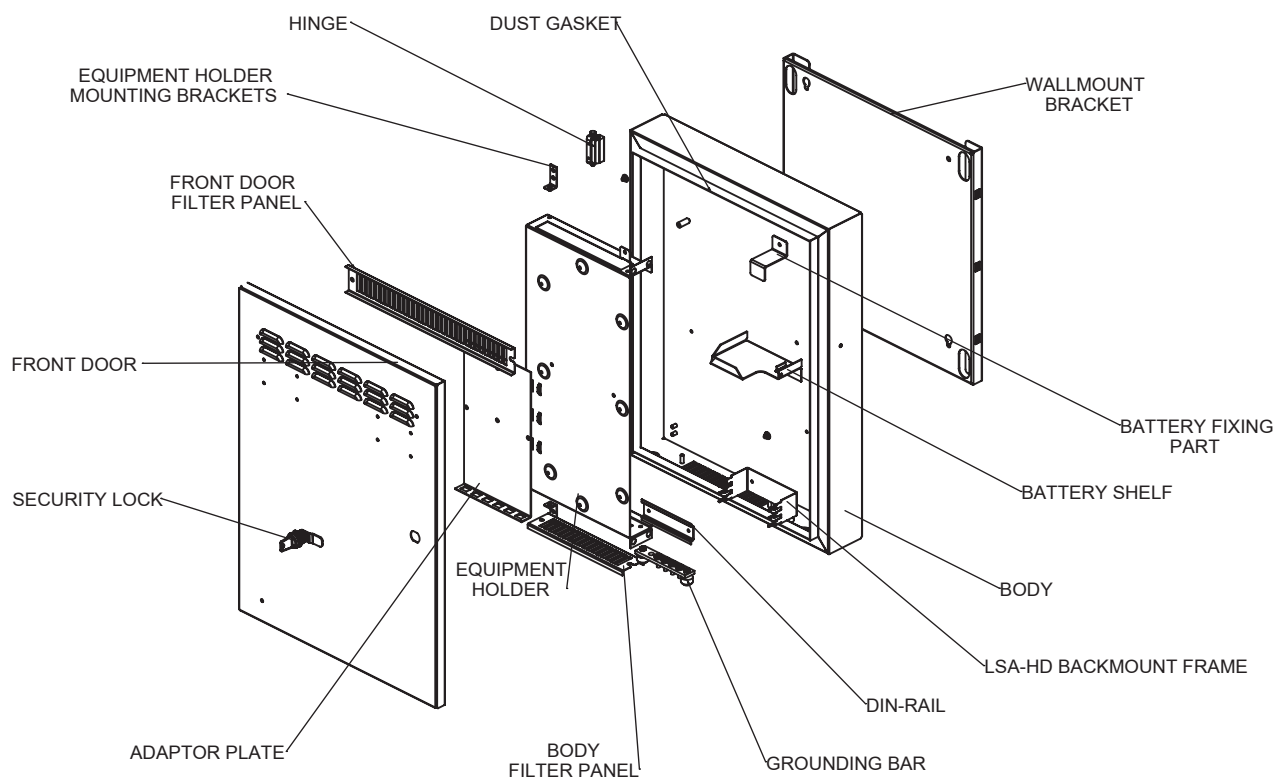

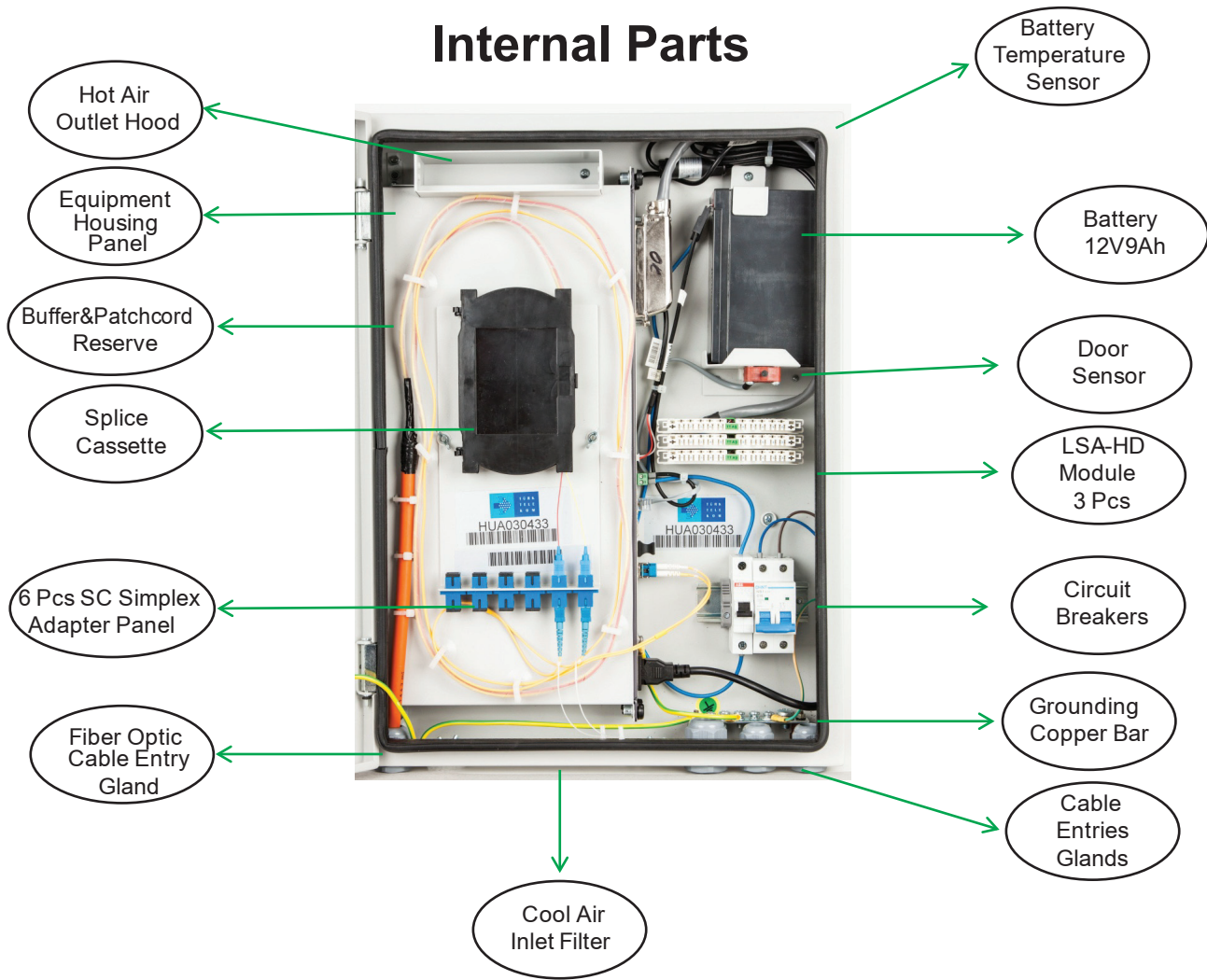

Order No*	Product Definition
ALF-CAB-FTTX-01-LG	FTTB Cabinet, Colour: Ral7035 Grey (1 pcs. Half-Cylinder high security lock, 1pcs. Fiber Optic Adaptor Panel, 3 pcs. PG16 Plastic Gland, 1 pcs. PG21 Plastic Gland, 6 pcs. Adhesive Bunny Clips,